

Display Unit

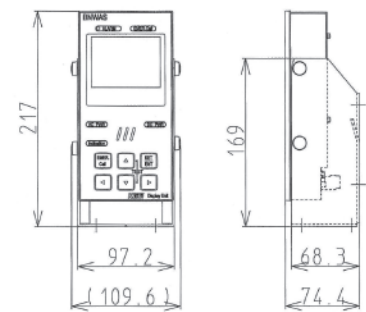

Junction Box

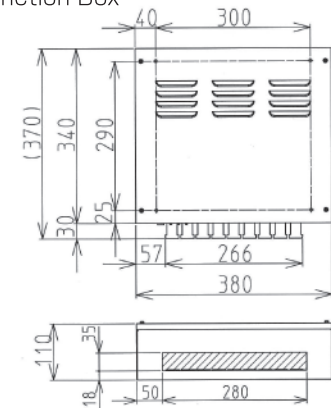

Buzzer Unit

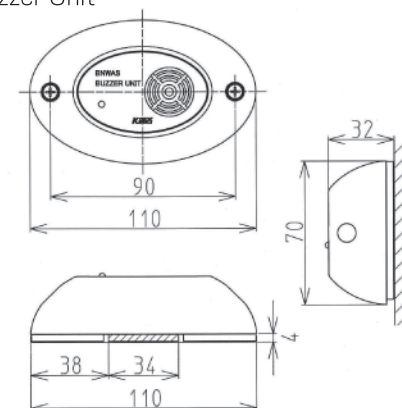

Flash Beacon (Flush Mount Type)

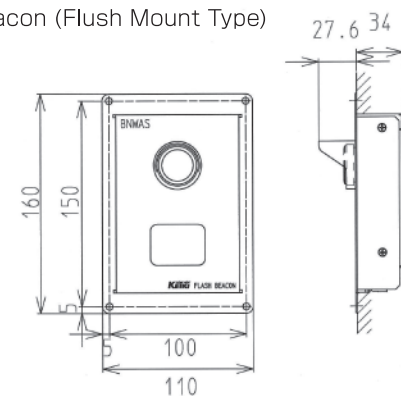

Flash Beacon (Wall Mount Type)

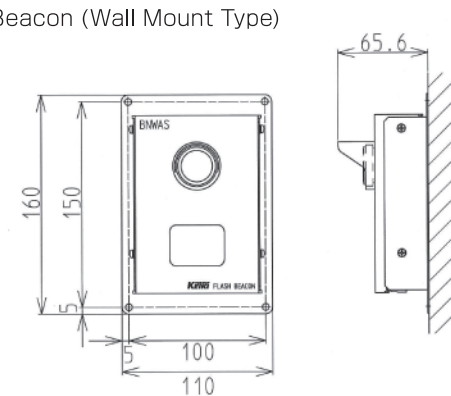

Water Proof Reset Unit

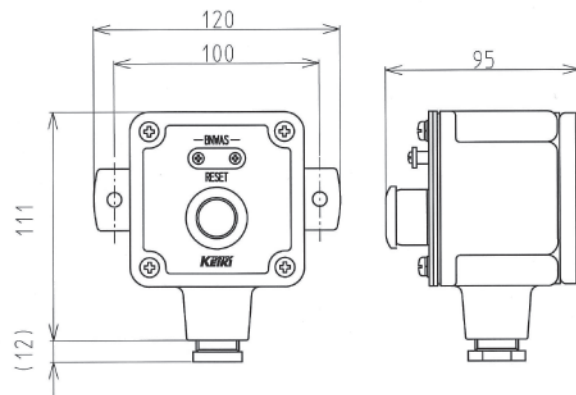

Reset Unit

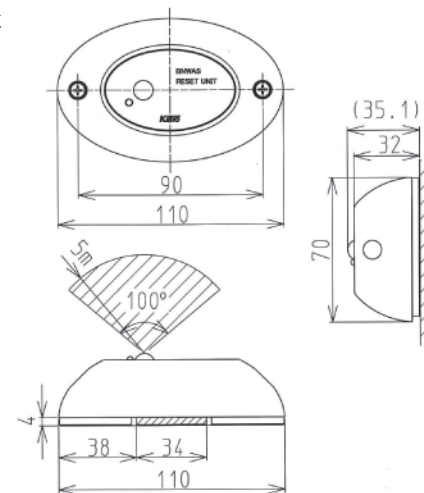

**TOKYO**  
**KEIKI**

TOKYO KEIKI INC.

Control Division I Marine Systems

Head Office	2-16-46, Minami-Kamata, Ohta-Ku, Tokyo 144-8551 JAPAN	Phone : +81-3-3737-8631	Facsimile : +81-3-3737-8666
Shanghai Representative Office	C-1605, Orient International Plaza, No.85 Lou Shan Guan Road, Shanghai 200336, CHINA	Phone : +86-21-3223-1252	Facsimile : +86-21-6278-7667
Busan Liaison Office	Shindonga bldg. Room 1003, 426-7 Bujeon-dong, Busanjin-gu, Busan 614-783, KOREA	Phone : +82-51-802-2190	Facsimile : +82-51-802-2188
TOKYO KEIKI U.S.A., INC	445 South Figueroa St., Suite 3770 Los Angeles, California 90071 U.S.A.	Phone : +1-213-689-4747	Facsimile : +1-213-689-0303

**TOKYO**  
**KEIKI**

# WAS-1000

Bridge Navigation Watch Alarm System (BNWAS)



System component

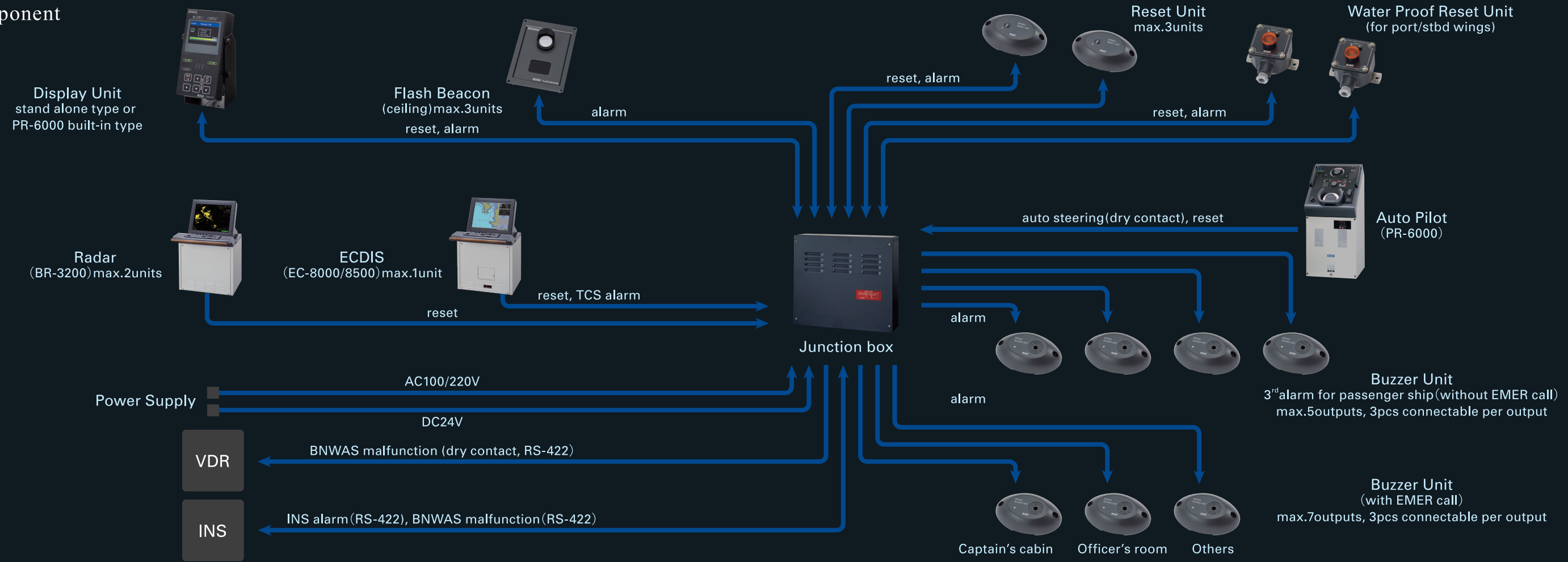

Bridge Navigation Watch Alarm System (BNWAS)

This system gives an alarm to prevent accidents at sea if it detects abnormalities in the watch officer's condition. If the system is not reset within the designated time period, the system will give visible and audible alarms in stages, as well as inform other officers.

In accordance with the SOLAS Chapter 5 regulation 19 revision, it is required that all new building vessels built on and after July 1, 2011 (passenger vessels and all other vessels of 150gt and over) have BNWAS installed. Also, existing vessels built before July 1, 2011, with relation to the vessel type and size, must also have BNWAS as per the SOLAS defined time periods.



Function and features

- Conforms with IMO MSC. 128 (75)
- Emergency Call transfer feature for selected rooms
- Self Diagnostic Check
- Timer reset option when connected with RADAR/ECDIS/AUTOPILOT
- Reset via motion sensor on the reset unit
- Option to build the display unit into the PR-6000 Autopilot for new building vessels

Components

- Display Unit .....×1pc
  - Junction Box .....×1pc
  - Reset Unit .....×Max 3pcs
  - Water Proof Reset Unit .....×Max 2pcs
  - Flash Beacon .....×Max 3pcs
  - Buzzer Unit .....×Max 36pcs
- Power  
AC100~220V 1φ 50/60Hz(Max.120VA)  
DC24V(Max.5A)

Display Unit



System condition with relation to watch observation

Each stage's display

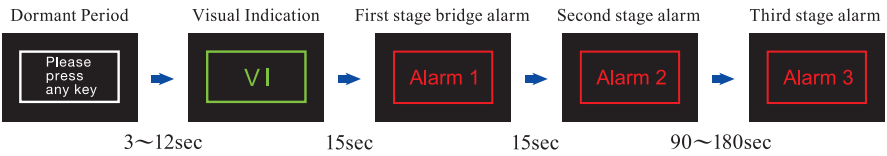

Alarm pattern for each stage

	VI	Alarm 1	Alarm 2	Alarm 3
Display	Green flash	Red flash	Red flash	Red flash
Display Unit		Red flash	Red flash	Red flash
Reset Unit	Orange flash	Orange flash	Orange flash	Orange flash
Water Proof Reset Unit	Orange flash	Orange flash	Orange flash	Orange flash
Flash Beacon	Green flash	Red flash	Red flash	Red flash
Buzzer Unit (Alarm2)			Selected units only	
Buzzer Unit (Alarm3)				

By performing the following, the system will reset and return to the Dormant Period

- Pushing a button on the Display Unit
- By movement near the motion sensor on the reset unit
- By pressing the button on the Water tight reset unit
- By performing an operation on the RADAR/ECDIS/or Autopilot (if connected to the BNWAS system)